



# Brammi

## Therapeutic Hypothermia System

# Quick Start Guide



1. Plug in power cable (device can start using internal battery if charged)

2. Insert temperature probes into labelled ports at front of device



3. Press power button to turn device on

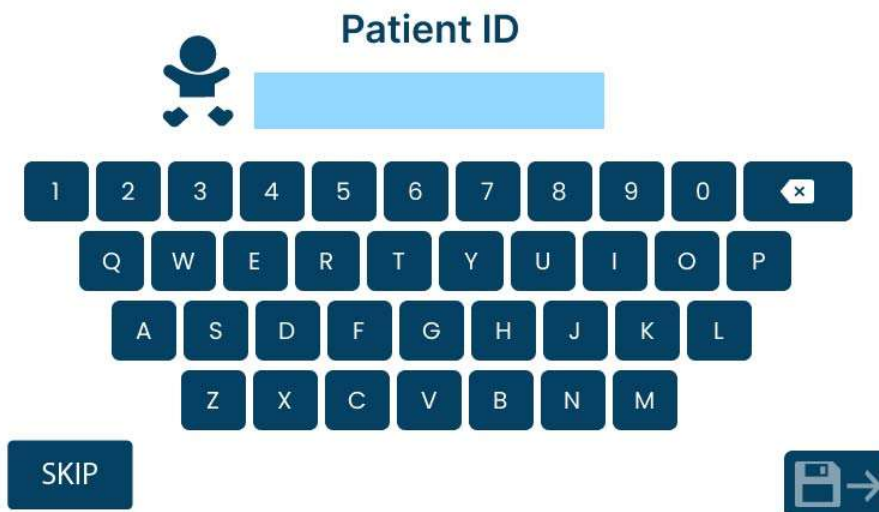

4. Insert Patient ID or SKIP (can be entered later)

5. Select "Filling" from main screen

Select therapy mode



- 1 Connect long hose to device.
- 2 Connect the long hose to mattress.
- 3 Connect the filled water jar to the device.
- 4 Squeeze the water jar to initiate the filling of water.
- 5 Press start  & observe the water filling status on the screen.
- 6 Shake the mattress for distribution of water with minimal bubbles.
- 7 Press stop  once mattress is completely filled with minimal air bubbles, then remove the jar.

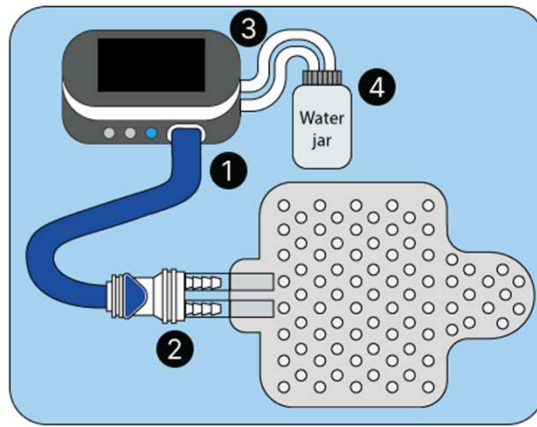

Skip



Tank level - 25%



6. Follow on-screen instructions to fill mattress

a. Connect long hose to device and to mattress



b. Connect water bottle and squeeze bottle



c. Press start  and rotate / shake mattress to remove air

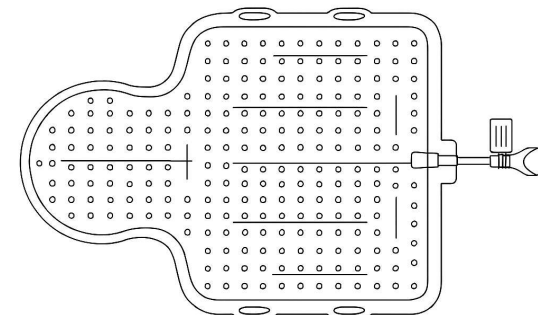

d. Press stop  when mattress filled, and Tank level 100%

## Select therapy mode



7. Horizon Brammi is now ready.  
Wrap mattress around infant

8. Select Therapy Mode (example below)

## 9. Select Servo Controlled Mode

Servo controlled mode 18-03-2025 16:30

Target core temperature: 33.5 °C

Cooling phase duration: 72 Hour(s)

Final core temperature: 36.5 °C

Heating phase duration: 06 Hour(s)

Temp change rate: 0.5 degree/hour

Core °C: 33.5

Skin °C: 35.0

Mattress °C: 30.0

Servo controlled mode

a. Adjust cooling target temperature and duration (or use default)

b. Adjust warming target and rewarming rate (or use default)

c. Press start

**Always refer to Instructions  
for Use (IFU) for further  
details, training or  
troubleshooting requirements**



Scan QR Code for link to IFU